

## ▶ Test Menu

### ▶ Thyroid

- TSH
- T3
- T4
- FT3
- FT4
- Anti-Tg\*
- Anti-TPO\*

### ▶ Allergy

- IGE\*

### ▶ Infectious Disease ▶ Brain Injury ▶ Anemia

- TB-IGRA
- HBs-Ag
- Anti-HCV
- HIV
- TP\*

- S100
- Aβ1-42\*
- AD7C-NTP\*

- VB12
- Folate
- Ferritin

### ▶ TORCH

- TOXO IgG\*
- TOXO IgM\*
- RUB IgG\*
- RUB IgM\*

### ▶ COVID-19

- IgG\*
- IgM\*
- Ag\*
- nAb\*

### ▶ Bone Metabolism

- 25-OH-VD
- PTH\*
- Calcitonin\*
- N-MID Osteocalcin\*

### ▶ Fertility

- β-HCG
- FSH
- LH
- PROL
- Progesterone
- Testosterone
- E2
- AMH
- E3\*
- INH-B\*

### ▶ Tumor Markers ▶ Inflammation

- CEA
- AFP
- tPSA
- fPSA
- CA125
- PG I
- PG II
- Gastrin-17
- CA19-9\*
- CA15-3\*

- PCT
- CRP
- SAA
- IL-6
- HBP

### ▶ Cardiac Markers

- cTnI
- Hs-cTnI
- cTnT
- Myo
- CK-MB
- NT-ProBNP
- D-Dimer
- H-FABP
- BNP
- Lp-PLA2\*
- ST2\*
- MPO\*
- Hcy\*
- GDF-15\*

### ▶ Diabetes

- Insulin\*
- C-Peptide\*

\* Upcoming

## Global Medical Engineering (BD) Ltd.

Corporate Office: 17/2, Topkhana Road (2nd Floor), Dhaka - 1000, Bangladesh.  
 Phone: +88 09678020555 Fax: +88 02 9576881 Cell: +8801404003500  
 E-mail: info@gmebd.com ; gmebd@hotmail.com Website: www.gmebd.com



All rights reserved. Features and specifications are subject to change without prior notice.



# AIKANG



# CLIA-mate Plus

## Chemiluminescence Immunoassay Analyzer

Aikang MedTech Co., Ltd

## ▶ CLIA-mate Plus

Principle	ALP-AMPPD chemiluminescence immunoassay
Sample type	Whole blood/Serum/Plasma
Throughput	30 t/hour
Test mode	Batch mode
Display	10.1-inch touch screen
Calibration frequency	100 days
Consumable	Disposable tips
Data storage	≥100,000
Communication port	USB/RS232/LAN/WIFI, available for LIS
Printer	Built-in thermal printer
Dimensions	575*325*605 mm
Weight	40 kg

## ▶ Easy Operation

**Step 1**

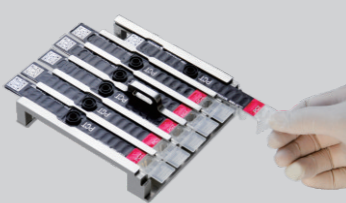

**Prepare reagent cartridges**  
Put reagent cartridges into the sample tray

**Step 2**

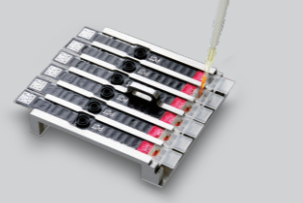

**Add sample**  
Add 80~100μl sample to the sample well of each reagent cartridge

**Step 3**



**Insert reagent cartridges**  
Insert up to 6 reagent cartridges into the analyzer, add one pipette tip for each test

**Step 4**



**Button start**  
Click "Start" on the touch screen, wait for the result

## ▶ All-in-one Reagent Cartridge

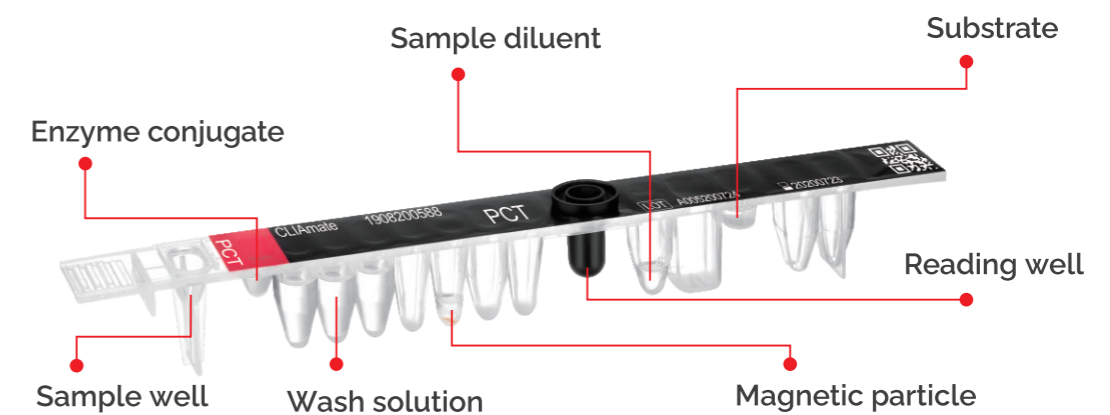

## ▶ Features

- ◎ Real CLIA technology with high sensitivity and accuracy
- ◎ Instrument with compact design at affordable cost
- ◎ Single test reagent cartridge without any reagent waste
- ◎ Specifications: 30 test/kit, 60 test/kit
- ◎ Disposable tip for each assay, reduce cross contamination
- ◎ Reagent information loading by external barcode scanner automatically
- ◎ 2 points calibration only, less calibration cost
- ◎ Android operation system, easy upgrading through USB port
- ◎ Easy operation and free maintenance
- ◎ Whole blood for cardiac and inflammation parameters, results within 15 minutes



## ▶ Principle

